

18 - 42 GHz Left Hand Circularly Polarised Spiral Antenna with No Mounting Flange fitted with a K type Connector

QMS-00961

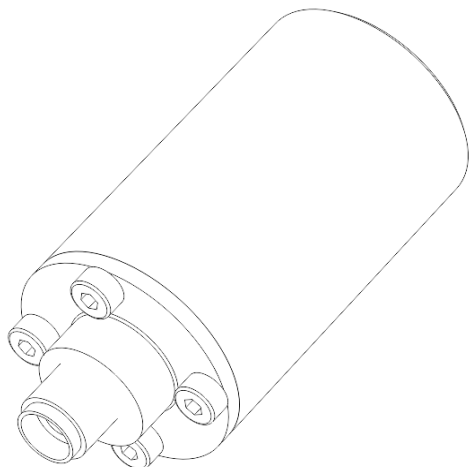

Please contact Steatite Antennas for a full interface control drawing.

Typical Specification

Frequency	18 to 42 GHz
Connector	2.92 Female
VSWR	Typically <2.5:1
Gain	0.5 to 3.7 dBiC
Axial Ratio	0.4 to 2.1 dB
3 dB Beamwidth	50.9 to 97.7 degrees
10 dB Beamwidth	96 to 153 degrees
Power	2W CW Typical
Size & Weight	20mm x 45mm Length, 26g nominal
Mounting	Clamping to external cavity
Environmental	DO160F
	Vibration: Fig 8-1, profile C (Fixed wing)
	Shock: 6g, 11ms TPS.
	MIL-STD-810H
	Storage Temp: -40°C to +70°C

Typical Gain

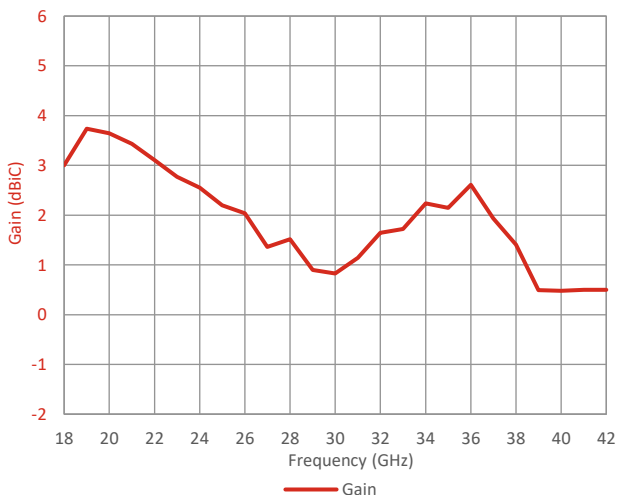

Typical Beamwidth

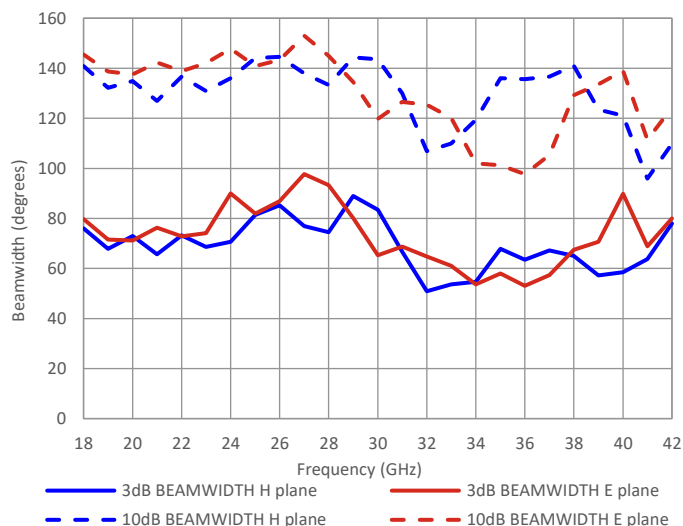

Typical VSWR

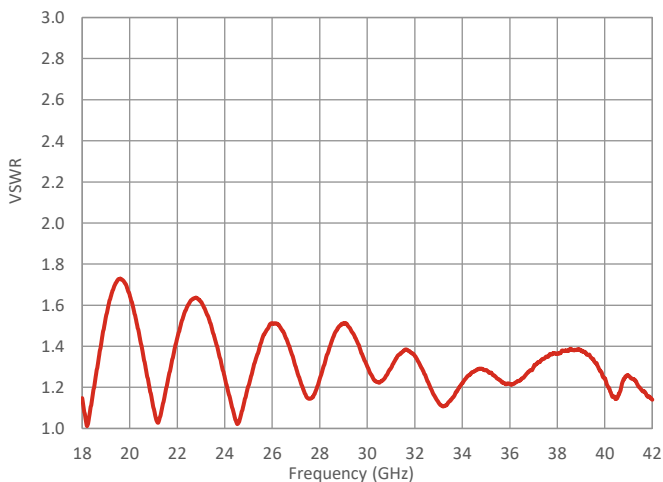

Typical Axial Ratio

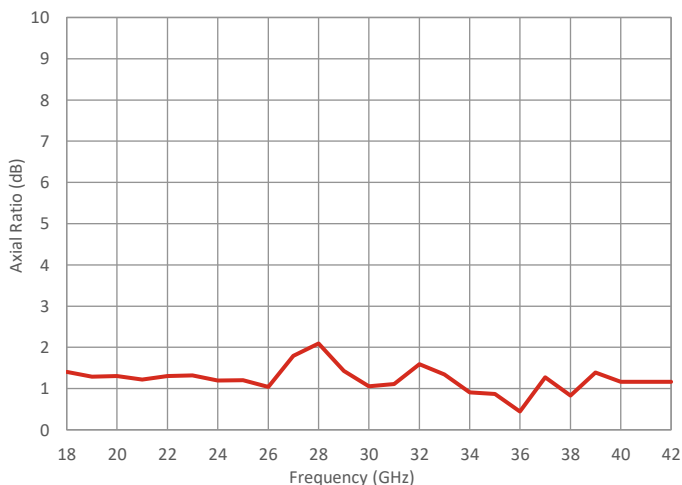

Steatite Antennas reserve the right to change and/or update this specification whereby it is deemed that this would improve either the production and/or performance specification of this part. Information herein should not be disclosed to a third party without the prior written consent of Steatite Antennas.





18 - 42 GHz Left Hand Circularly Polarised Spiral Antenna with No Mounting Flange fitted with a K type Connector

**18 GHz**

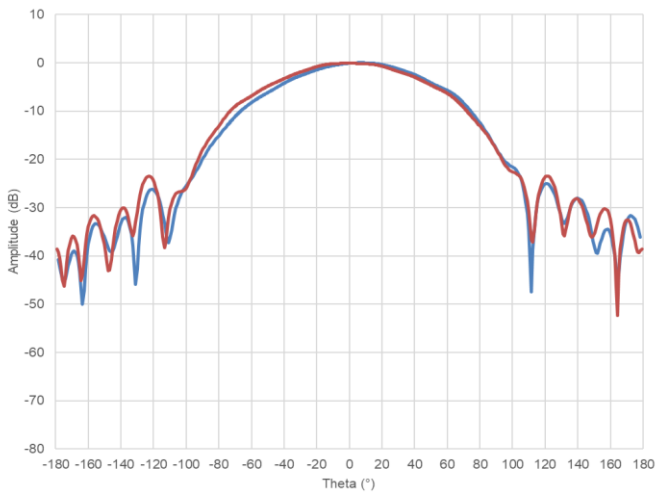

**22 GHz**

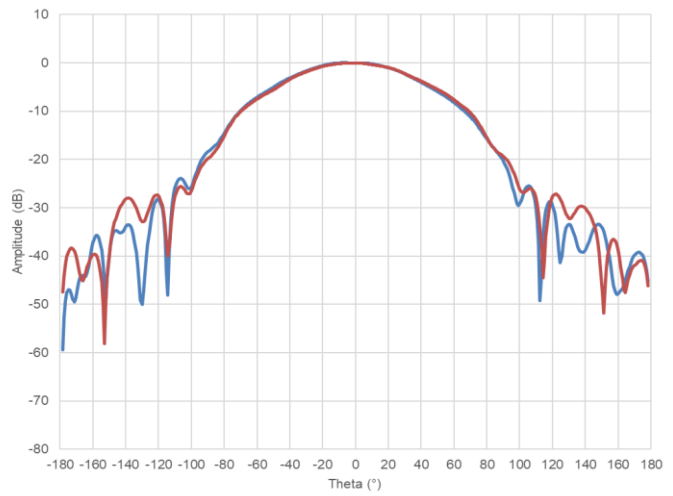

**26.5 GHz**

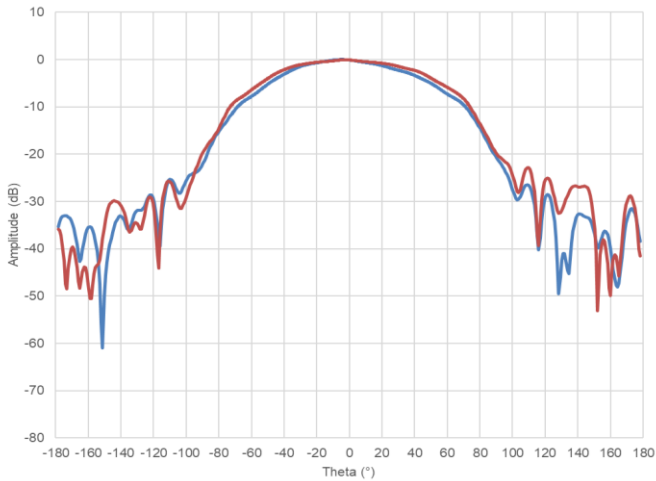

**28 GHz**

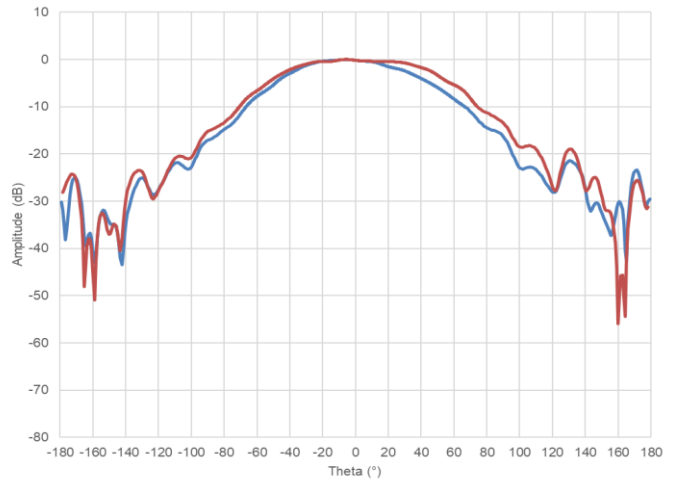

**32 GHz**

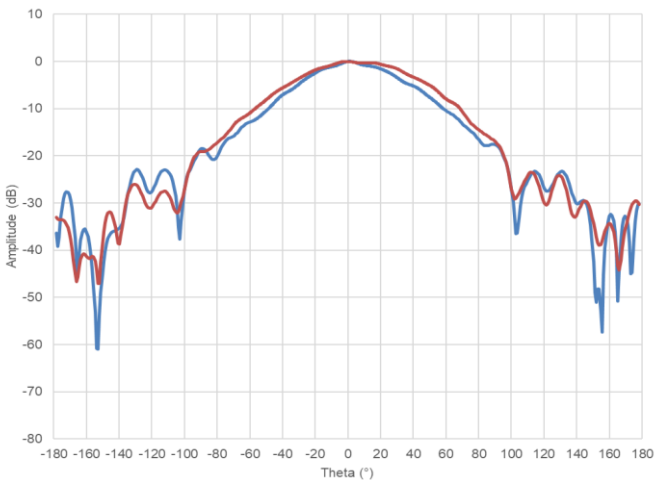

**40 GHz**

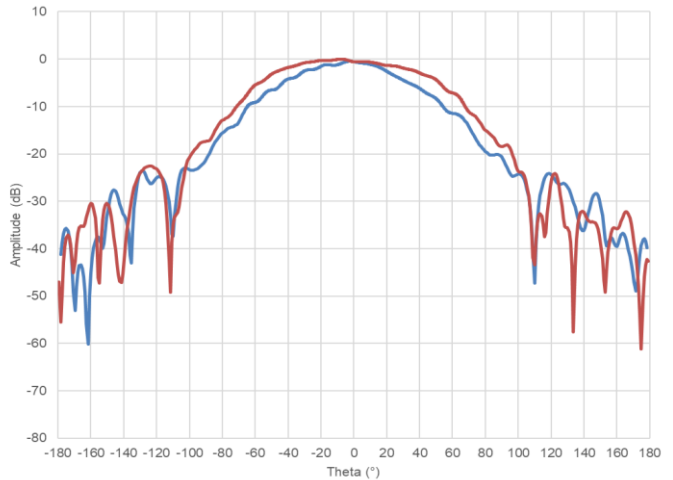

Steatite Antennas reserve the right to change and/or update this specification whereby it is deemed that this would improve either the production and/or performance specification of this part. Information herein should not be disclosed to a third party without the prior written consent of Steatite Antennas.

