

0.5 - 22 GHz Right Hand Circularly Polarised Spiral Antenna fitted with an SMA type Connector and Radome

**QMS-01113**

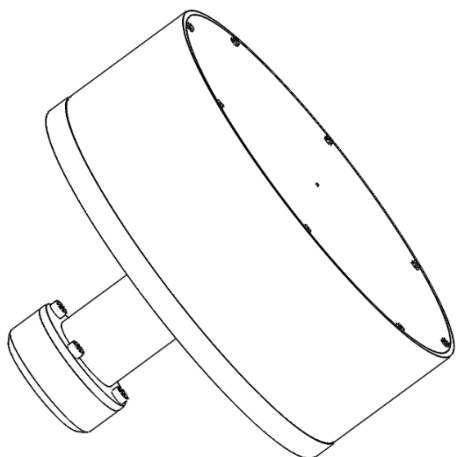

Please contact Steatite Antennas for a full interface control drawing.

**Typical Specification**

<b>Frequency</b>	0.5 to 22 GHz
<b>Connector</b>	SMA type jack
<b>VSWR</b>	Typically < 2.0:1 above 0.8 GHz
<b>Gain</b>	-7.9 to 4.9 dBi
<b>Axial Ratio</b>	0.2 to 7.5 dB
<b>3 dB Beamwidth</b>	52.5 to 119.5 degrees
<b>10 dB Beamwidth</b>	111 to 180 degrees
<b>Power</b>	2 Watt c.w.
<b>Size &amp; Weight</b>	Ø154mm x 122mm long, 800g nominal
<b>Mounting</b>	5 x M5 x 8mm deep, 130mm PCD
<b>Environmental</b>	<b>MIL-STD-810H</b> Shock: 20g, 11ms Terminal Peak Sawtooth, Storage Temperature: -40°C to +70°C <b>DO160F</b> Vibration: Figure 8-3, curve M, Altitude: 50,000ft (15,200m)

**Typical Gain**

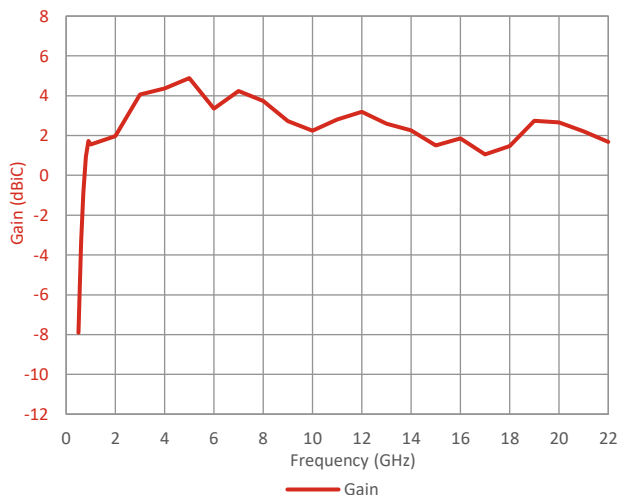

**Typical Beamwidth**

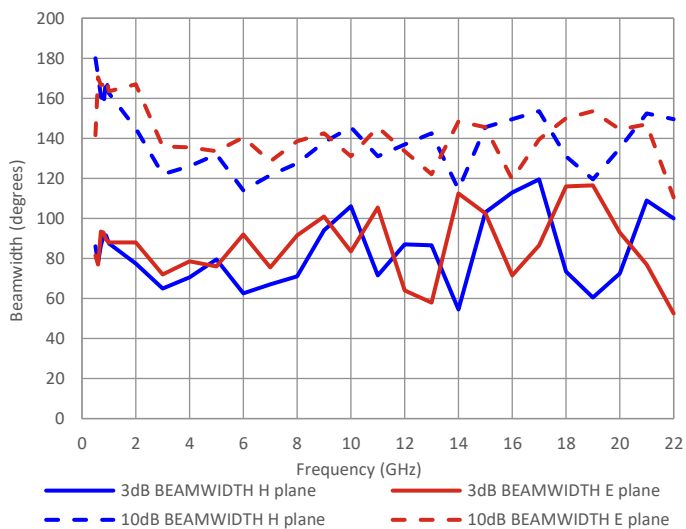

**Typical VSWR**

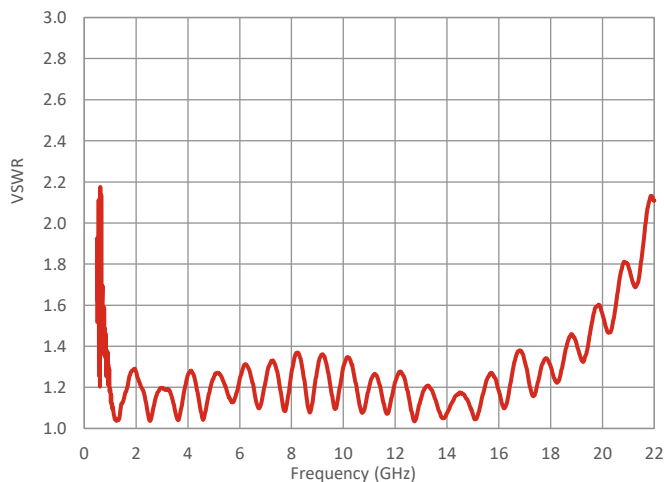

**Typical Axial Ratio**

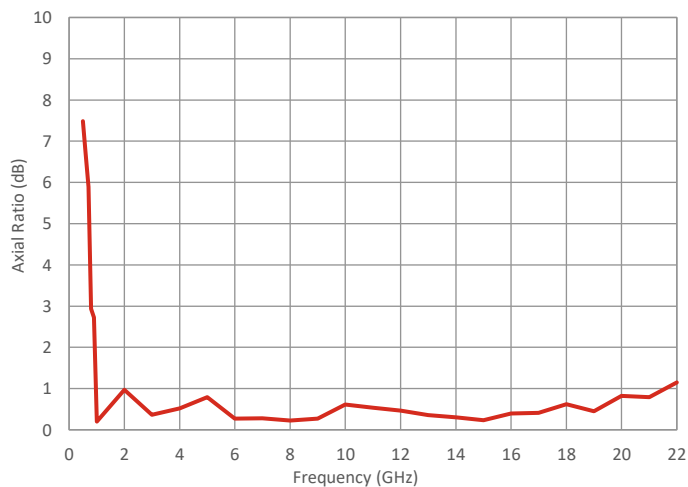

Steatite Antennas reserve the right to change and/or update this specification whereby it is deemed that this would improve either the production and/or performance specification of this part. Information herein should not be disclosed to a third party without the prior written consent of Steatite Antennas.

