

0.5 - 22 GHz Left Hand Circularly Polarised Spiral Antenna fitted with an SMA type Connector and Radome

QMS-01160

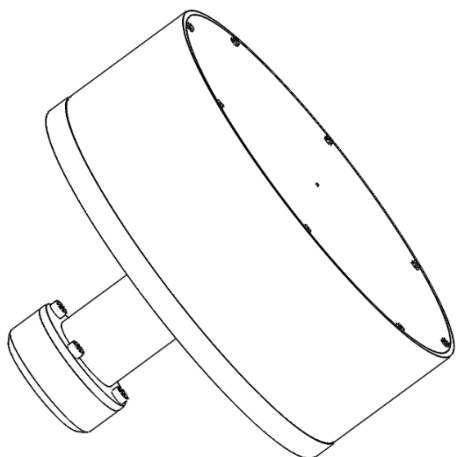

Please contact Steatite Antennas for a full interface control drawing.

Typical Specification

Frequency	0.5 to 22 GHz
Connector	SMA type jack
VSWR	Typically < 2.0:1 above 0.8 GHz
Gain	-7.9 to 4.9 dBi
Axial Ratio	0.2 to 7.5 dB
3 dB Beamwidth	52.5 to 119.5 degrees
10 dB Beamwidth	111 to 180 degrees
Power	2 Watt c.w.
Size & Weight	Ø154mm x 122mm long, 1.1kg nominal
Mounting	5 x M5 x 8mm deep, 130mm PCD
Environmental	MIL-STD-810H

Shock: 20g, 11ms Terminal Peak Sawtooth,
Storage Temperature: -40°C to +70°C

DO160F

Vibration: Figure 8-3, curve M, Altitude: 50,000ft (15,200m)

Typical Gain

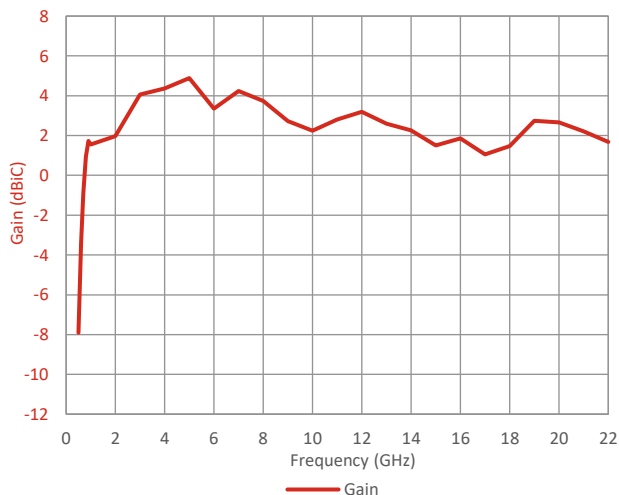

Typical Beamwidth

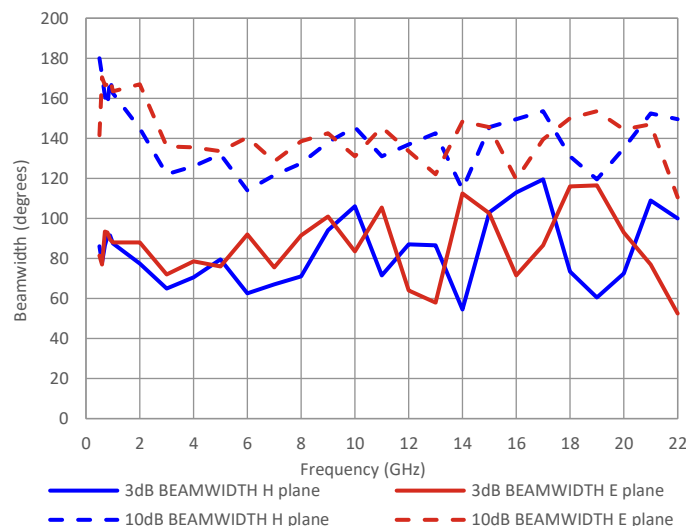

Typical VSWR

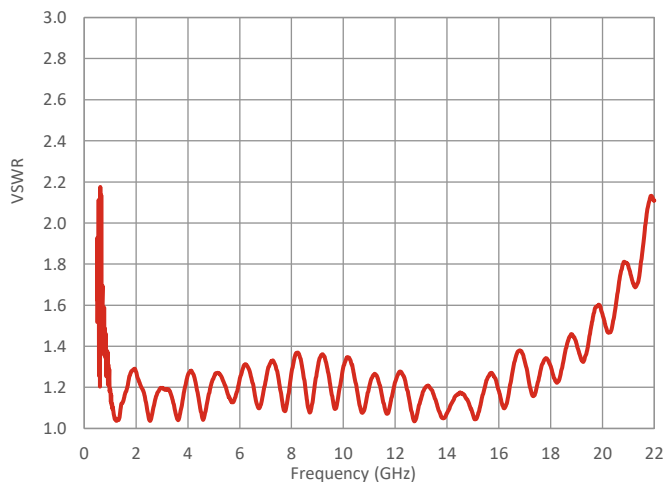

Typical Axial Ratio

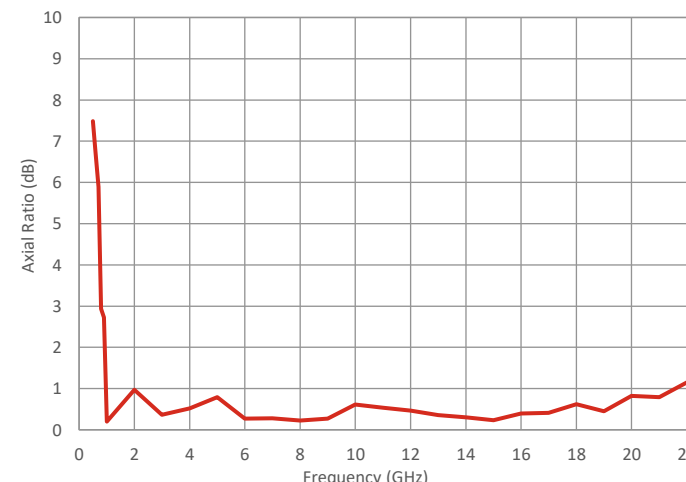

Steatite Antennas reserve the right to change and/or update this specification whereby it is deemed that this would improve either the production and/or performance specification of this part. Information herein should not be disclosed to a third party without the prior written consent of Steatite Antennas.

